

1. Removal of Nexion Furniture

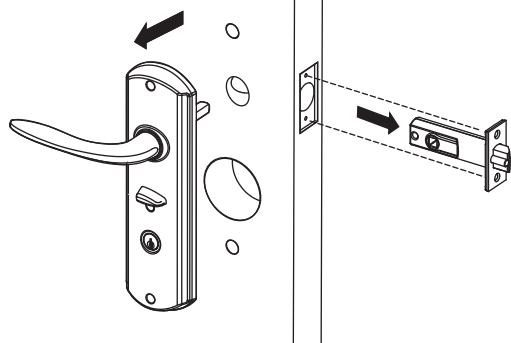

- Take off your internal and external Nexion Furniture and latch as shown above.

2. Removal of Nexion Strike

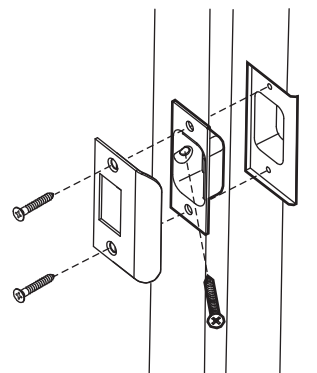

- Remove your Nexion Strike plate from door jamb as shown above.

3. Unity Entrance Lock door preparation

Existing Nexion door preparation with Unity template.

Line up the template with the Ø54mm hole at the bottom.

When performing a retrofit install, there is no need to drill the Ø12.5mm hole for the DPS.

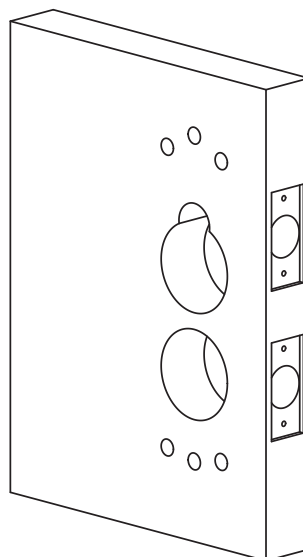
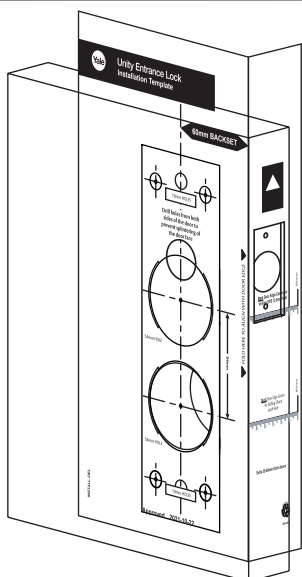

Nexion with added Unity door preparation

- Use the Unity Entrance lock installation template to prepare the door as shown above, which includes 2 by Ø54mm holes and 4 by Ø10mm holes.

4. Install the Yale Unity entrance lock

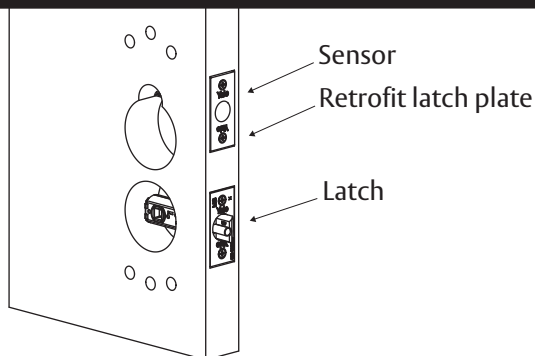

- Install the Yale Unity entrance lock latch at bottom hole and retrofit latch plate to cover the old Nexion latch hole.
- Install door position sensor as shown above.

5. Install door position magnet & strike

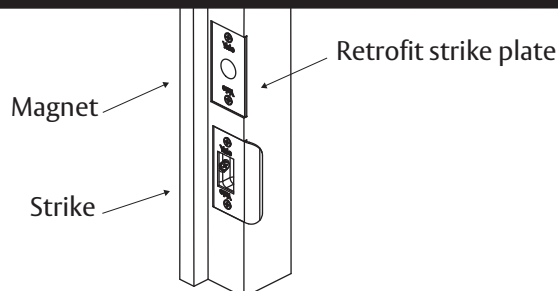

- Select the retrofit strike plate based on the thickness of the door jamb and fit the door position magnet.
- Fit the Yale Entrance lock strike plate into position as shown above.

